

CAMPUS PLAN

BIRD'S EYE VIEW

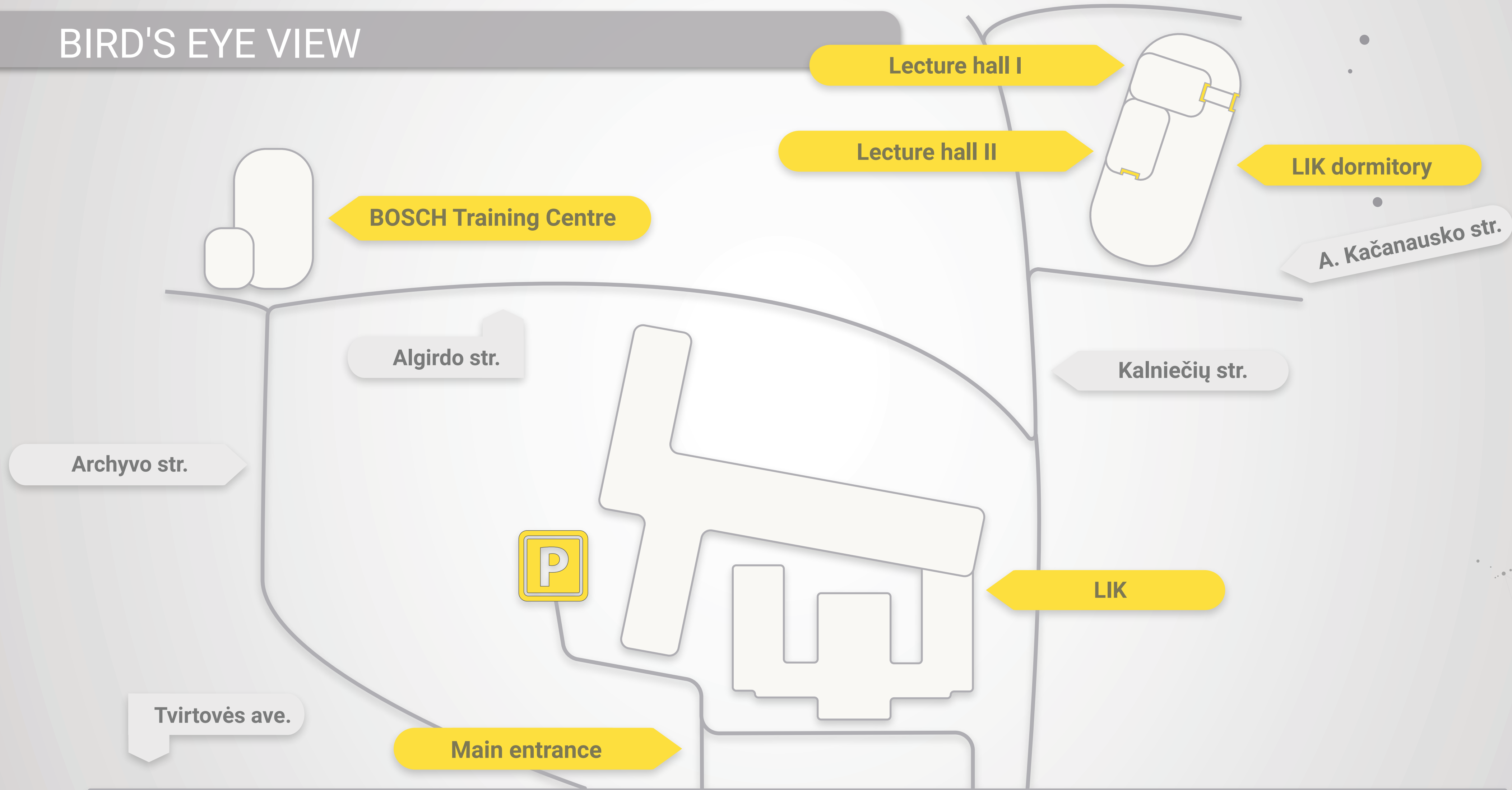

FLOOR PLAN

BASEMENT · MAIN BUILDING

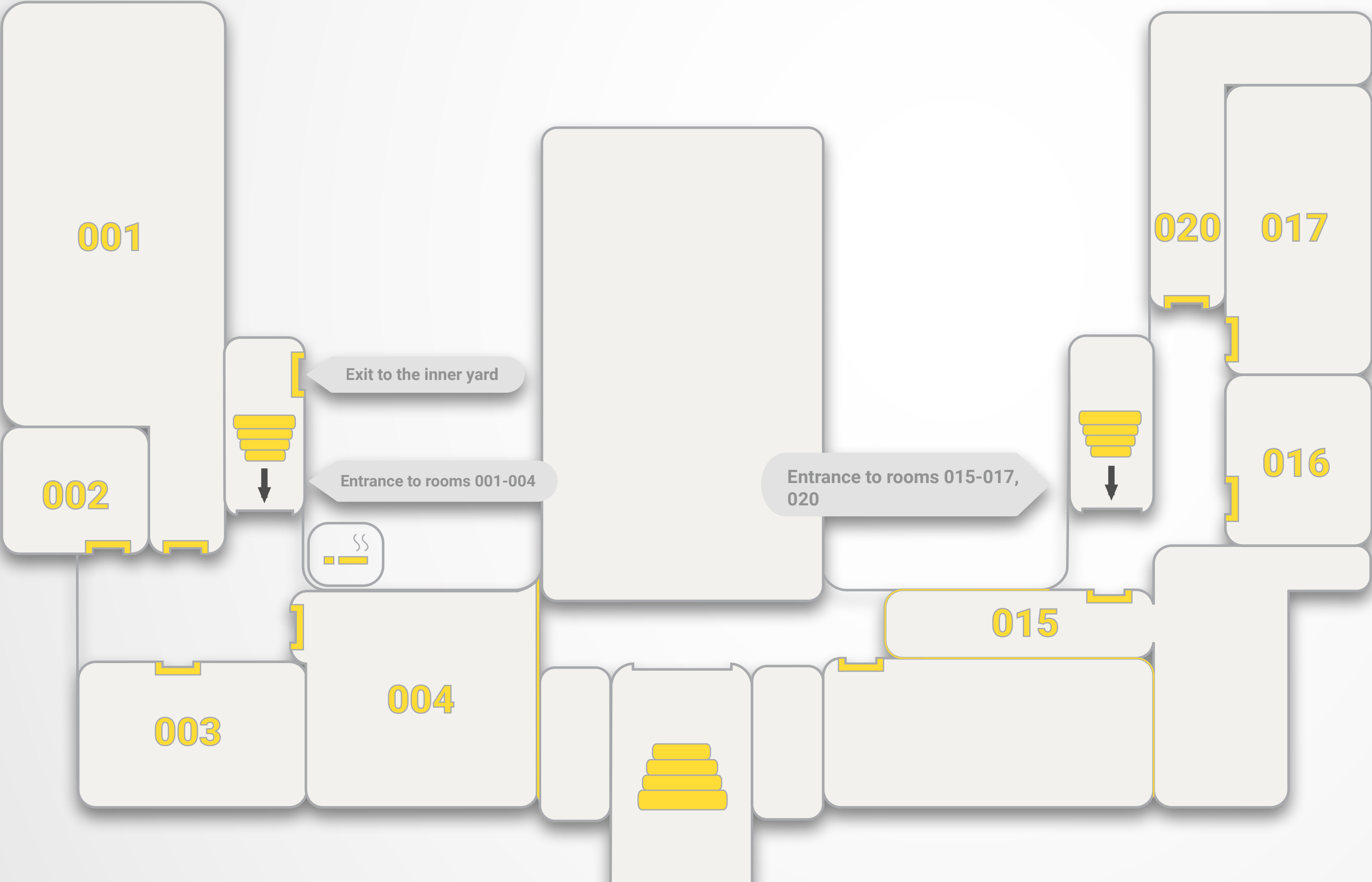

Lietuvos
inžinerijos
kolegija



- | | |
|-----|--|
| 001 | Laboratory of Electrical Machinery and High Voltage Technology |
| 002 | Radio Equipment Testing Laboratory |
| 003 | Power System Protection and Automation Laboratory |
| 004 | Electric Station and Substation Equipment Laboratory |
| 015 | Metal Works Laboratory |
| 016 | Automobile Exploitation Materials Laboratory |
| 017 | Car repair classroom |
| 020 | Electronics preparation room |

FLOOR PLAN

FIRST FLOOR · MAIN BUILDING

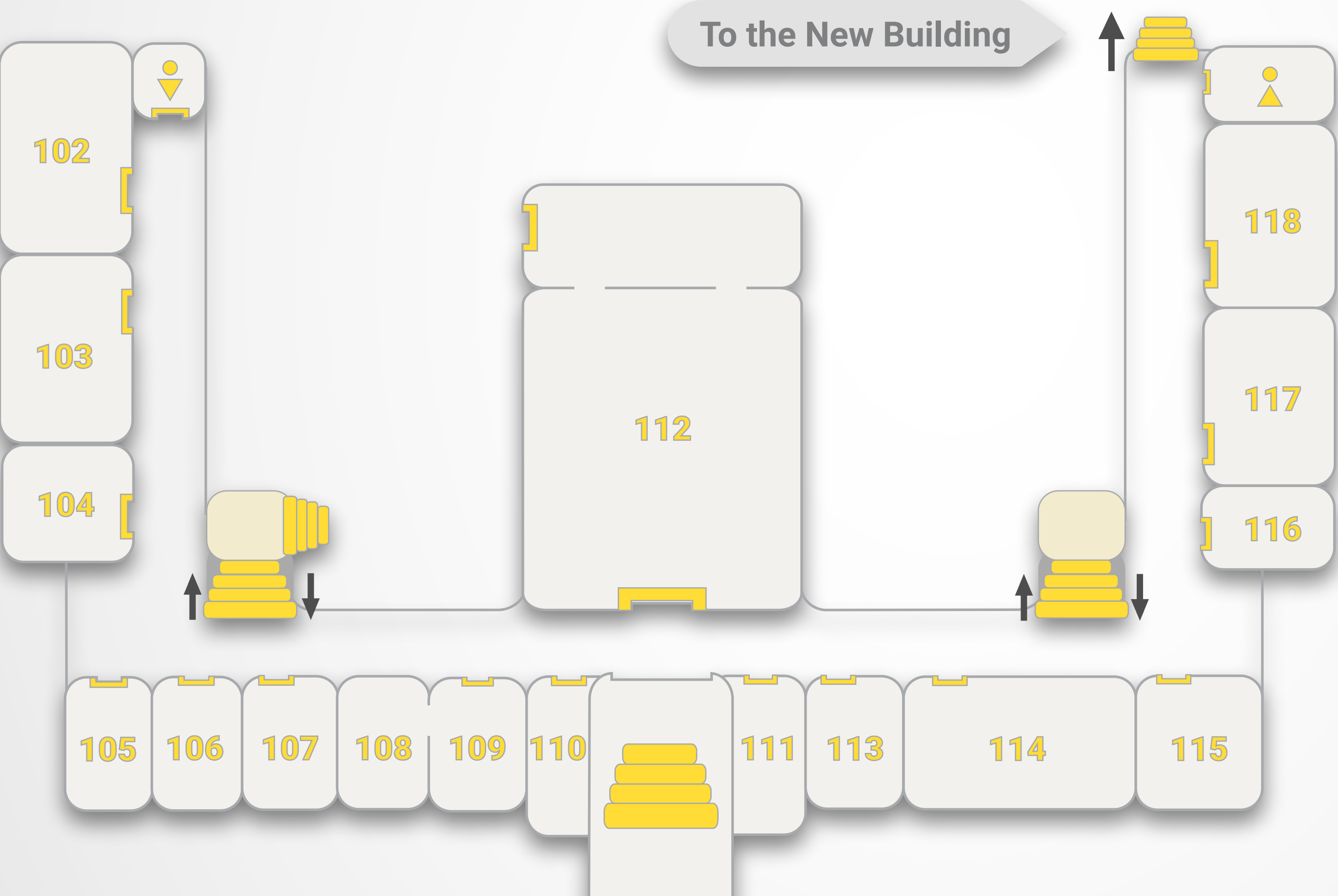

102, 103, 114,
115, 117, 118

Classrooms

104 Head of Engineering Competence
Department & Head of the Study
Programmes Department

105 Meeting room

106 Head of Infrastructure Department &
Public Procurement Specialist

108-109 Director & Administrator of the Director's Office

110 Head of Administration

111 Chief Accountant

112 Prof. Julijonas Gravrokas Lecture Hall

113 Department of Finance and Accounting

116 Department of HR and Administration



Lietuvos
inžinerijos
kolegija



FLOOR PLAN

SECOND FLOOR · MAIN BUILDING

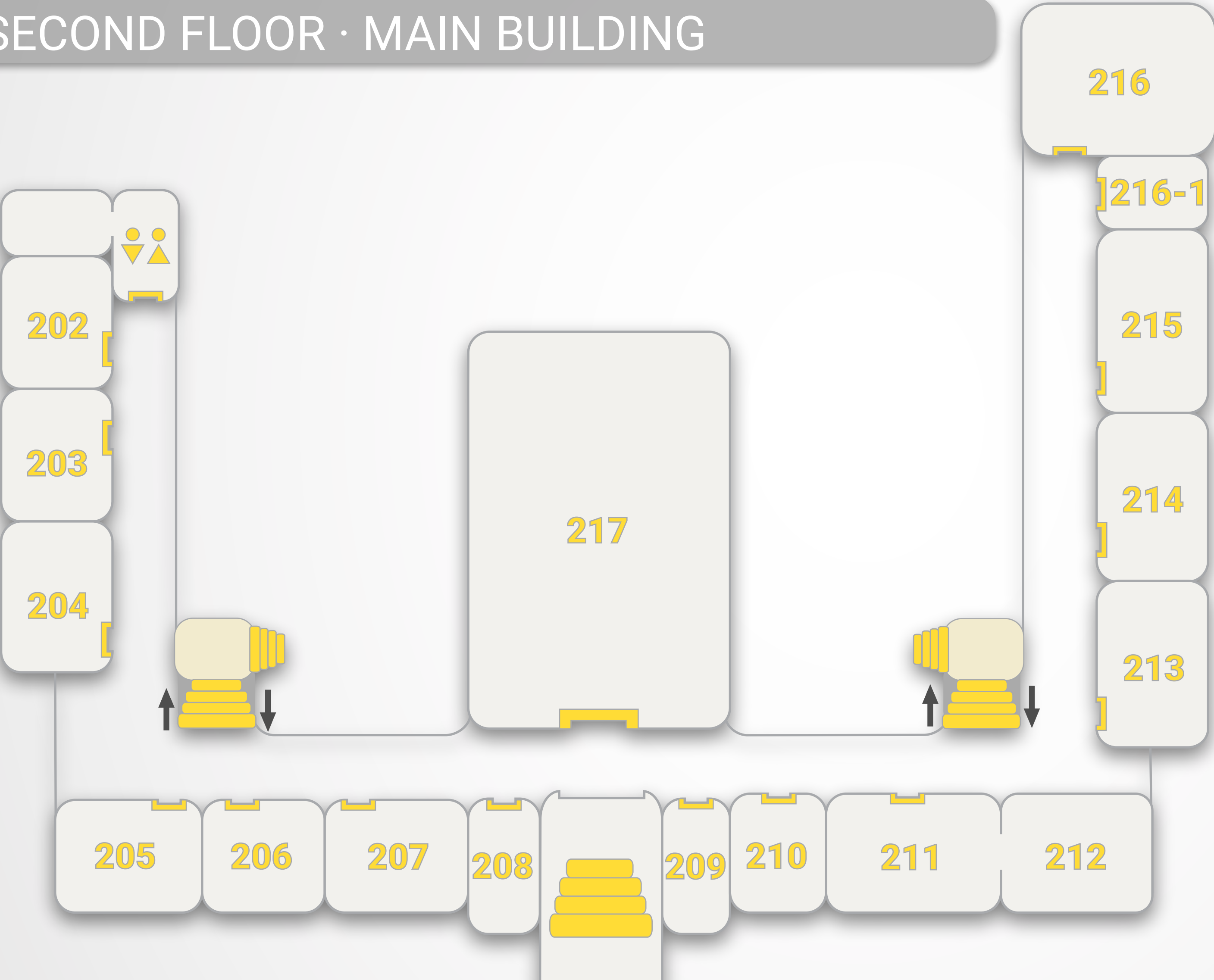

202 – 206	Classrooms
207	Study Organisation Office
208	Head of Study Organisation Office
209	Study Accounting Administrator & Organiser of the Study Process
210 – 213; 215	Classrooms
216	Lecture hall
216-1	Staff room



Lietuvos
inžinerijos
kolegija

FLOOR PLAN

THIRD FLOOR · MAIN BUILDING

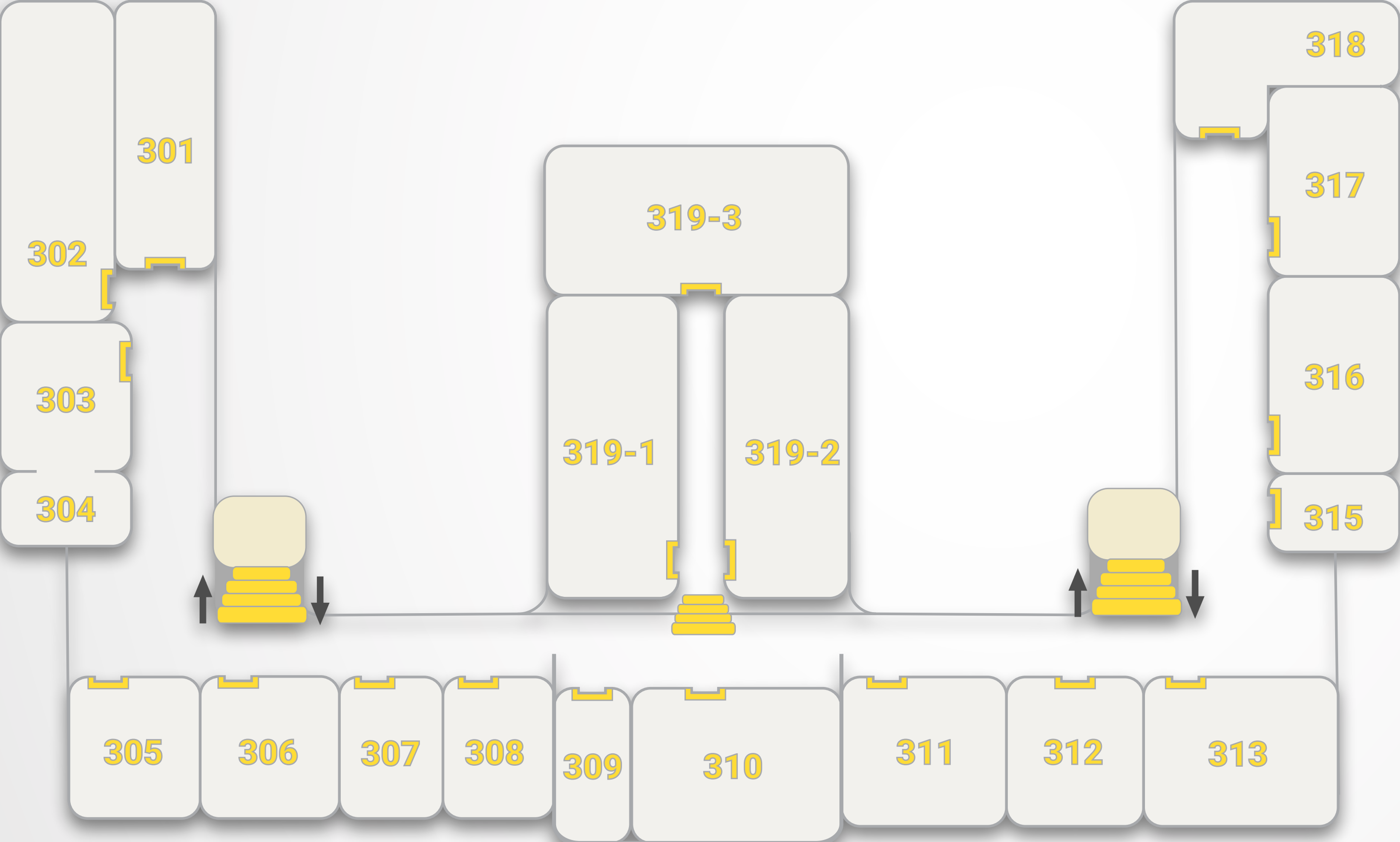

301-303	Classrooms
305	Staff room
306; 312; 313; 316; 317; 318	Classrooms
307	Head of the Aircraft Maintenance Engineering Study Programme
308	Museum collection
309	Head of the Automotive Engineering Study Programme & Coordinator of International Relations
310	Museum
311	Transport & Mechanical Engineering Study Programmes Committee
315	Staff room



Lietuvos
inžinerijos
kolegija



FLOOR PLAN

MANSARD · MAIN BUILDING

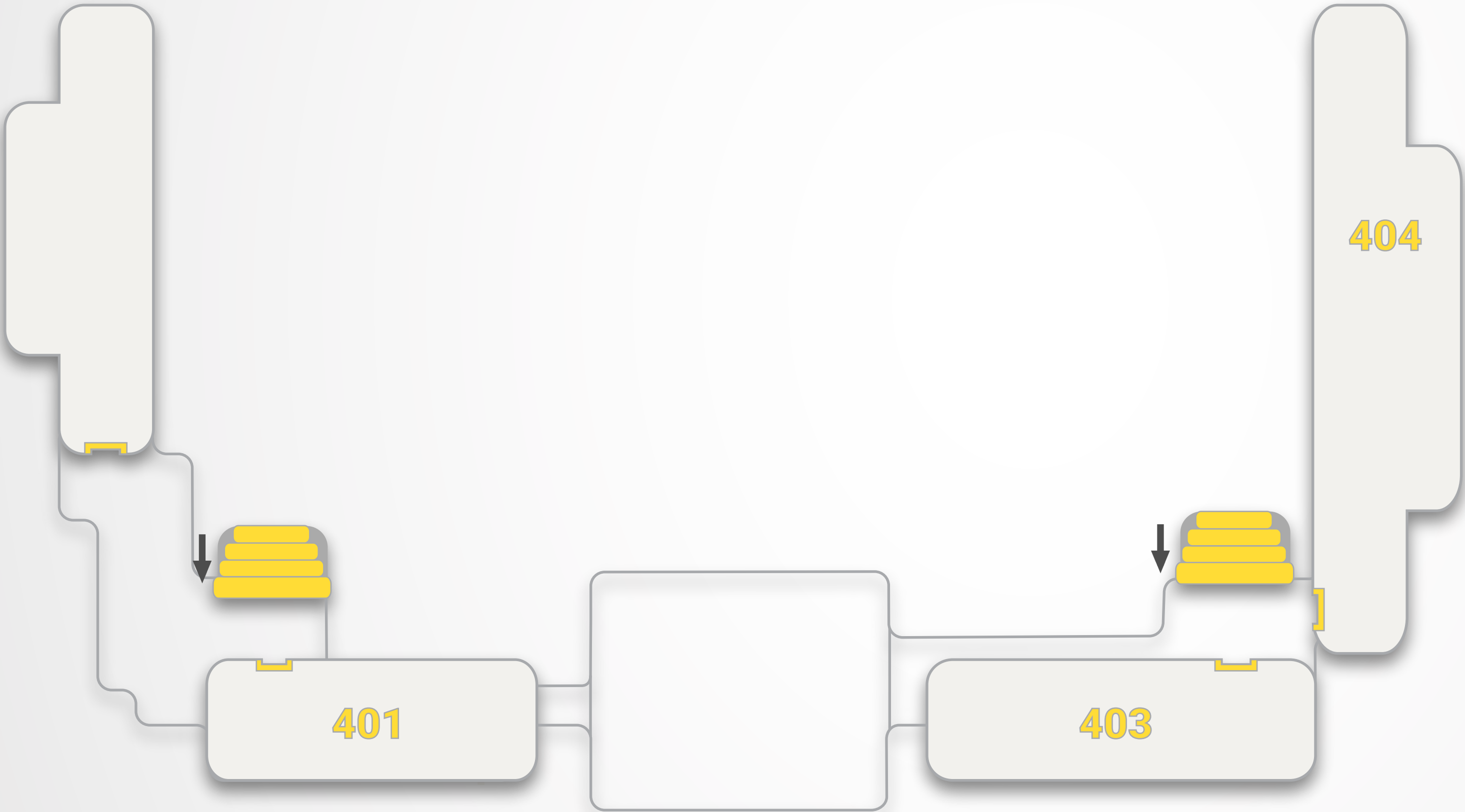

401	Classroom
403	Car repair classroom
404	Mechanics classroom



Lietuvos
inžinerijos
kolegija



FLOOR PLAN

BASEMENT · NEW BUILDING

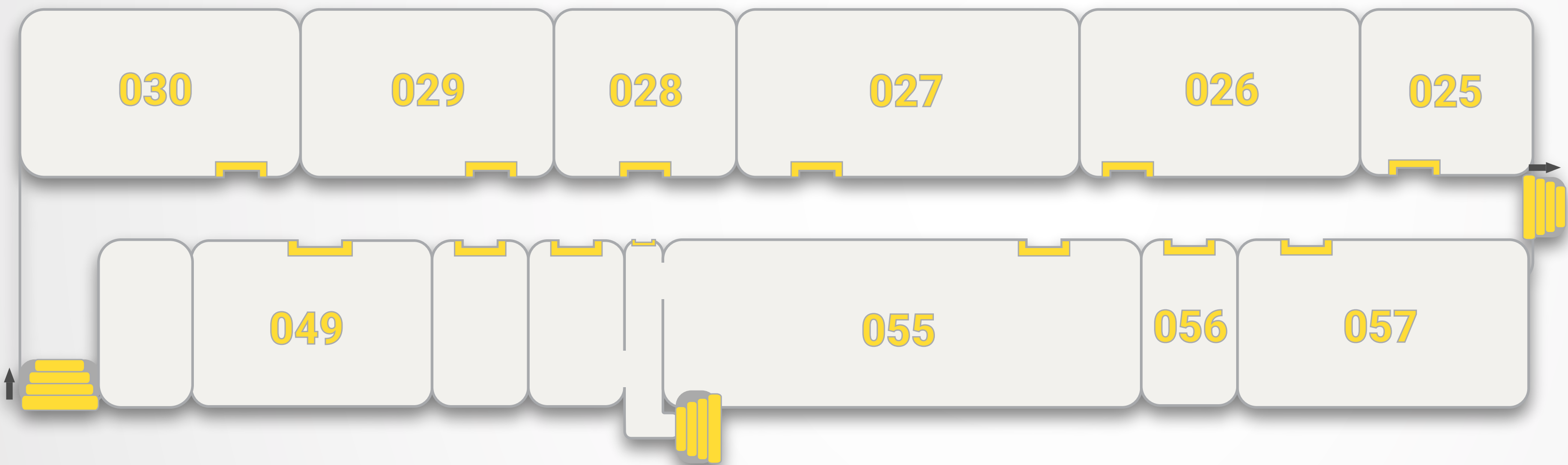

025 - 030	Laboratories
049	Leisure area for students
055	VW Car Structure Laboratory
056	LIK Racing Division
057	Laboratory



Lietuvos
inžinerijos
kolegija



FLOOR PLAN

FIRST FLOOR · NEW BUILDING



Lietuvos
inžinerijos
kolegija



126	Technical Support Center/ Publishing Center
127	Classroom
128	LIK Students Union
129-130	Classrooms
131	IT classroom
132-133	Classrooms
143	Library & Reading room
144	Study space for students



FLOOR PLAN

SECOND FLOOR · NEW BUILDING

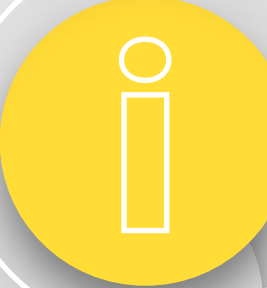

	
227	Study Communication Office
228-230	Classrooms
231	Students Lounge
232-240	Study space for students
241	Office of the heads of study programmes of the Civil Engineering field
242	Classroom



Lietuvos
inžinerijos
kolegija

FLOOR PLAN

THIRD FLOOR · NEW BUILDING



Lietuvos
inžinerijos
kolegija



327	Kitron Electronics Assembly Laboratory
328-334; 337; 338	Classrooms
333	Office of the heads of study programmes in the Electrical and Electronics Engineering fields

FLOOR PLAN

BASEMENT · GYM



034	Exercise machines
036	PE teachers' room
040	Changing room A
041	Changing room B
043	Welding Laboratory
046; 047	Maintenance staff
048-S	Gym inventory storage room
048	Main gym



Lietuvos
inžinerijos
kolegija



FLOOR PLAN

FIRST AND SECOND FLOOR · AVIATION ENGINEERING CENTRE



Lietuvos
inžinerijos
kolegija

To the New Building



Second floor

135

138

136

137-1

137-2

137-3

137

To the second floor



136	Classroom
137-1; 137-2; 137-3	Laboratories
137	Aviation Engineering Centre
138	Event space
234	Classroom

